

PROPOSED UNIT 3
 84,000 sqft 7,804 sqm
 Total Gross Internal Area

Footprint	80,000 sqft	7,432 sqm
First Floor offices	4,000 sqft	371.6 sqm

12m clear to underside of Haunch
 Finish floor level - 52.00 AOD
 All areas are measured as gross internal

Proposed Ground Floor
 1 : 200

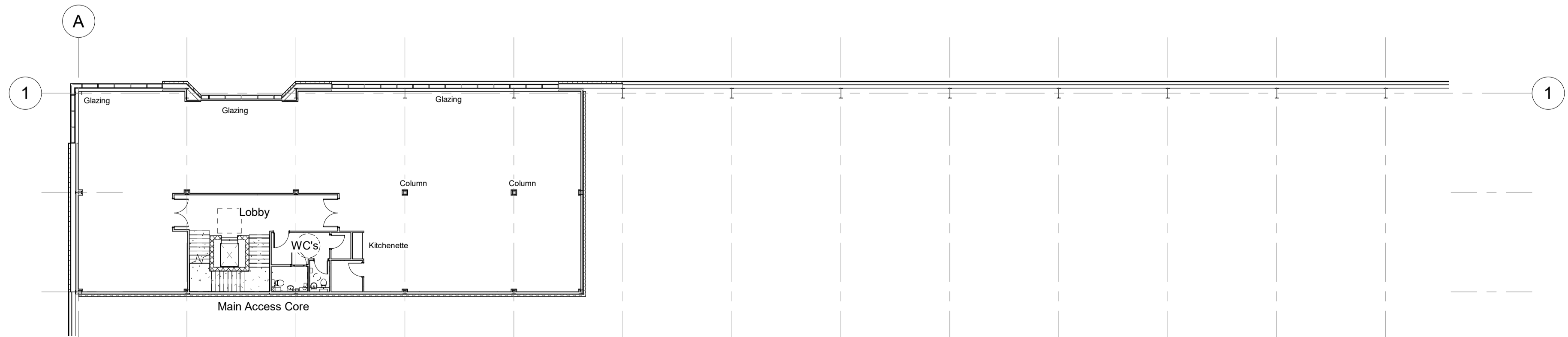

Proposed First Floor Offices
 1 : 200

Project Title	Proposed Industrial Development	Drawing Title	Unit 3 GA Plans
Client	Wyngrave Limited	Job-Dwg No.	17475 - (P)131
Status	PLANNING	Scale	As indicated
Scale	As indicated	Drawing Size	A1
Drawn By	NBB	Checked By	JMR
Date	04.22		



This drawing is copyright and may not be reproduced in whole or part without written authority. Do not scale off this drawing.