



To Let

Unit 2 Portobello Trade Park, Birtley DH3 2SB

- Highly Prominent Trade Counter
- GIA 648 m² (6,891 ft²)
- 80,000 Cars Passing Daily
- Ground Floor Offices
- 7m Eaves
- LED Lighting
- 12 Car Parking Bays
- Up and Over Loading Door



Location

Portobello Trade Park occupies a highly prominent position off Portobello Road in Birtley, adjacent to the A1(M). The estate has excellent access to and from the A1(M), lying between Junction 64 and 65, which are both within 1 mile of the site.

The A1(M) in turn leads to the wider regional and national road networks both north and south. Access to the A19 Trunk Road, which is the other main arterial route through the region, is within 6 miles of the estate via the A1231 Sunderland Highway.

Description

Portobello Trade Park comprises 100,000 sqft of trade, industrial and warehouse space. The development offers a range of units specifically aimed at occupiers seeking prominence and accessibility.

The unit provides a semi-detached property of steel frame construction with steel profile elevations above and to the roof.

Internally the property has an entrance hallway which leads to open plan office with CAT 2 lighting, data trunking, double glazed windows and gas fired heating. In addition, there are WC facilities and a kitchen area.

The warehouse provides a 30kn/m² concrete floor with LED lighting, together with an eaves height of 7m and a loading door of 4m wide by 5m high which opens out onto a large concrete service yard surrounded by attractive landscaped areas.

Accommodation

	Sqm	Sq ft
Warehouse	595	6,411
Offices	53	570
Total GIA	648	6,981

Business Rates

The premises are listed on the Valuation Office Agency website with RV of **£48,000** from 1st April 2023.

Terms

The property is available on a new lease for a term to be agreed at a rent of **£69,950** per annum exclusive.

VAT

All figures quoted are exclusive of VAT which may apply.

Services

We understand that the property is connected to mains supplies of water, three phase electricity and drainage to the main sewer.

Energy Performance Certificate (EPC)

The Energy Performance Asset Rating is B(26).

Energy Performance Asset Rating

More energy efficient



Net zero CO₂ emissions

A 0-25

B 26-50

C 51-75

D 76-100

E 101-125

F 126-150

G Over 150

Less energy efficient

26 This is how energy efficient the building is.

Viewing

Via agents HTA Real Estate

Nick Atkinson

nick@htare.co.uk

0191 245 3011

07950 319060

Russell Taylor

russell@htare.co.uk

0191 245 3012

07710 735566

Or joint agent Naylor's Gavin Black 0191 232 7030

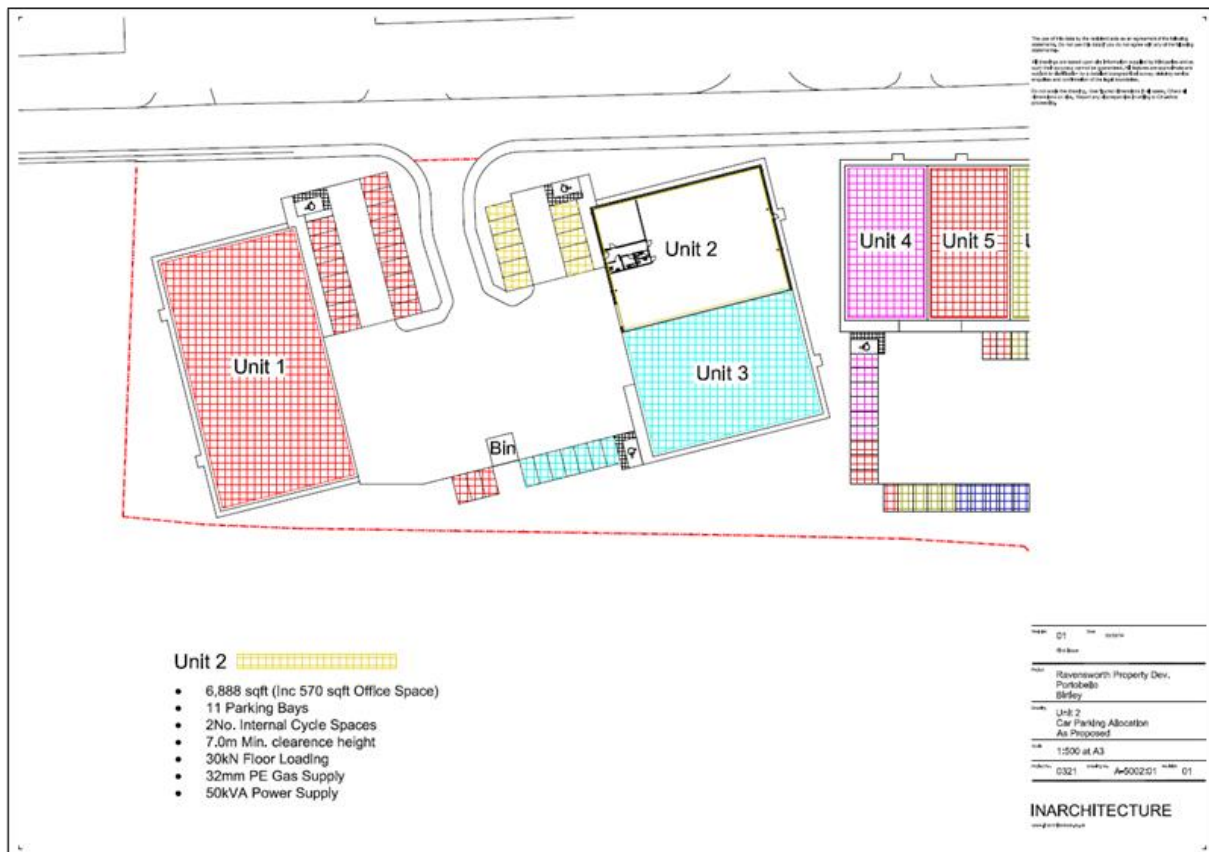

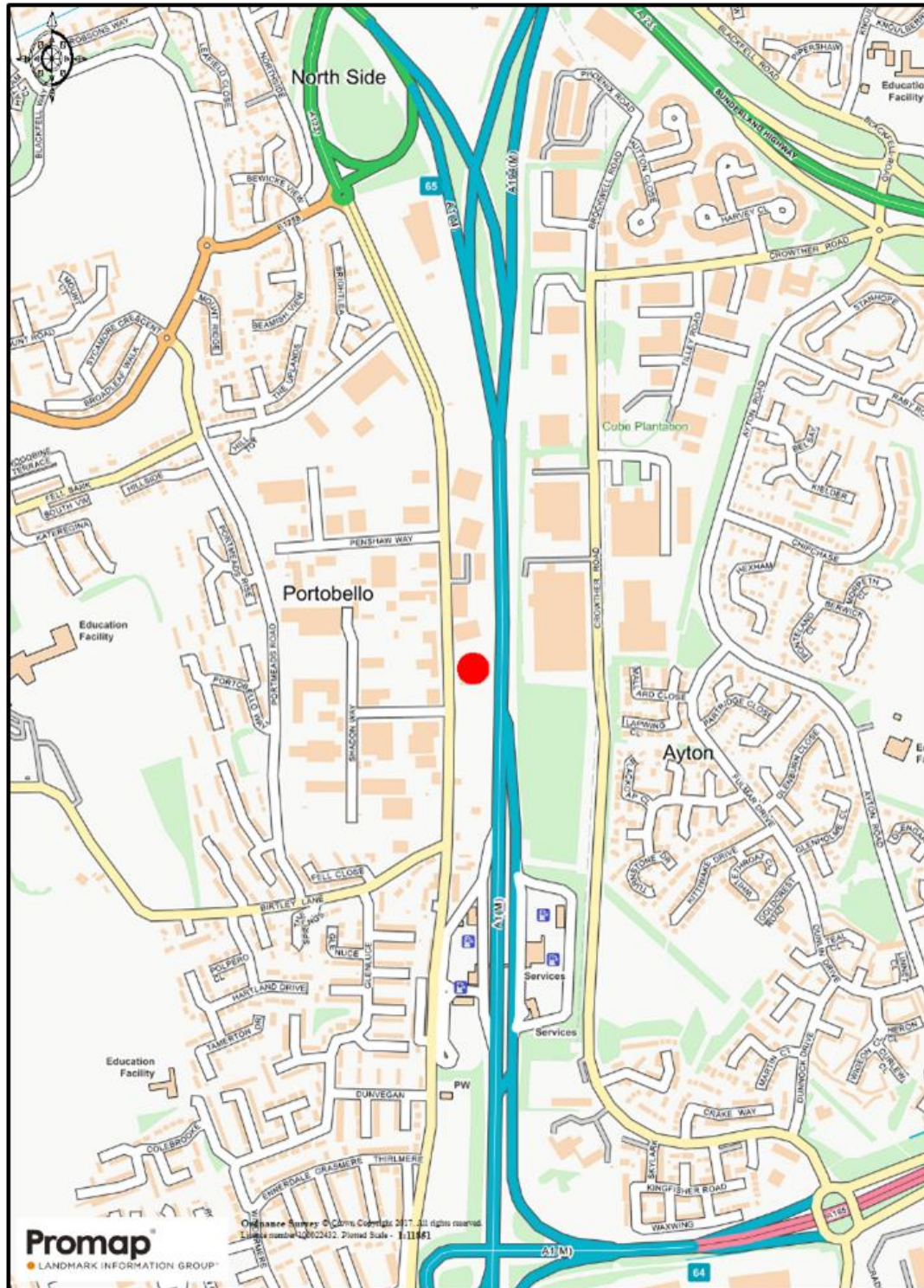

IMPORTANT NOTICE

Particulars: These particulars are not an offer or contract, nor part of one. You should not rely on statements by HTA Real Estate Ltd in the particulars or by word of mouth or in writing ("information") as being factually accurate about the property, its condition or its value. Neither HTA Real Estate Ltd nor any joint agent has any authority to make any representations about the property, and accordingly any information given is entirely without responsibility on the part of the agents, seller(s) or lessor(s). Photos etc: The photographs show only certain parts of the property as they appeared at the time they were taken. Areas, measurements and distances given are approximate only. Regulations etc: Any reference to alterations to, or use of, any part of the property does not mean that any necessary planning, building regulations or other consent has been obtained. A buyer or lessee must find out by inspection or in other ways that these matters have been properly dealt with and that all information is correct. VAT: The VAT position relating to the property may change without notice. HTA Real Estate Ltd is a limited company registered in England with registered number 8724530. Registered Office: Fernwood House, Fernwood Road, Jesmond, Newcastle upon Tyne NE2 1TI.