

# Glover Industrial Estate Tyne & Wear

Available to Let  
4,228 – 5,048 sq ft (393 – 469 sq m)



Well established location



Good access to A1(M) and A19



Loading doors to main area



Forecourt parking and loading



Mains services



Rental incentives available

# Glover Industrial Estate

Units 2 and 7, Tower Road, Glover Industrial Estate, Washington, Tyne & Wear NE37 2SH



## Description

Modern business units providing high quality production space on a well maintained estate.

## Location

Washington New Town is ideally situated between the A1(M) and A19 providing easy access to the North East Region. Newcastle, Sunderland and Durham are within 15 minutes' drive time and Teesside is within 20 minutes. Glover Industrial Estate is located off the A195 Northumberland Way close to the A1231 Sunderland Highway giving direct dual carriageway access to both the A1(M) and A19.

## EPC

Energy Performance Certificate is available upon request.

## VAT

VAT will be payable where applicable.

## Terms

Available on new full repairing and insuring lease.

## Legal Costs

All parties will be responsible for their own legal costs incurred in the transaction.

## Viewing / Further Information

Please contact:

**Hugh Hodgson**  
hugh.hodgson@mileway.com  
07553 893 703

Property owned by **Mileway**

This document (together with any attachments, appendices, and related materials, the "Materials") is provided on a confidential basis for informational due diligence purposes only and is not, and may not be relied on in any manner as legal, tax, investment, accounting or other advice or as an offer or invitation to lease the property referred to herein or otherwise enter into any other transaction, agreement or arrangement, nor shall it or the fact of its distribution form the basis of, or be relied on in connection with, any lease or other contract or any commercial or investment decision. If such offer is made, it will only be made by means of heads of terms (collectively with any additional documents, the "Heads of Terms"), which would contain material information not contained in the Materials and which would supersede and qualify in its entirety the information set forth in the Materials. In the event that the descriptions or terms described herein are inconsistent with or contrary to the descriptions in or terms of the Heads of Terms, the Heads of Terms shall control. None of Mileway nor any of its respective affiliates makes any representation or warranty, express or implied, as to the accuracy or completeness of the information contained herein and nothing contained herein should be relied upon as a promise or representation of any kind.

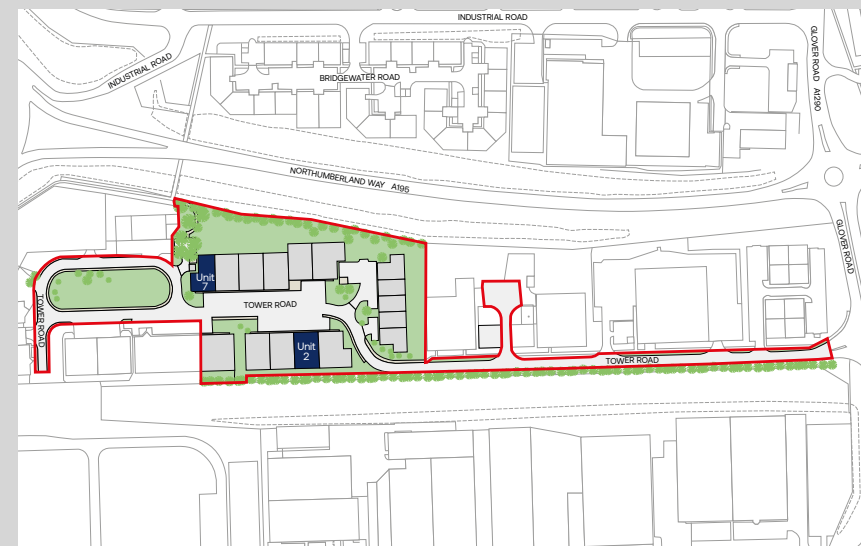
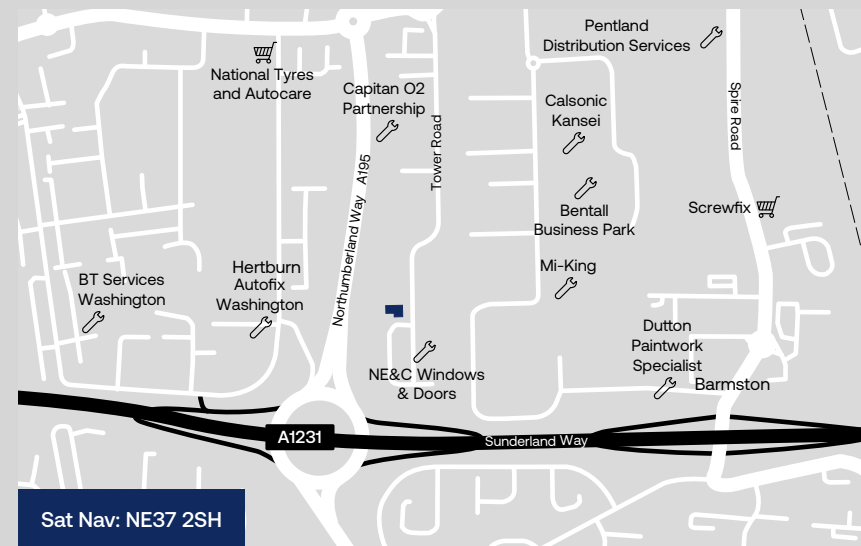

## Accommodation

Floor areas are as follows:

Unit	Area (sq ft)	Area (sq m)	Rent (per annum)
Unit 2	5,048	496	£25,000
Unit 7	4,228	393	£21,000

**Mileway**